

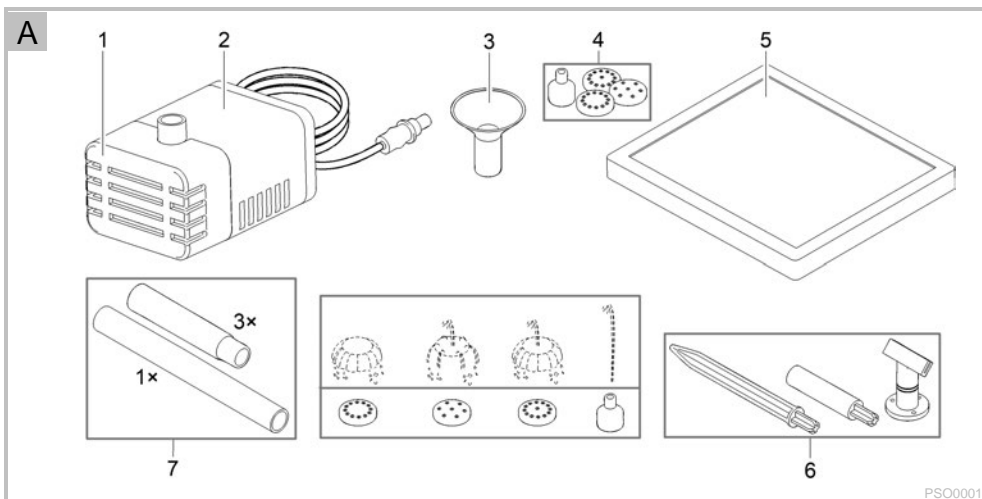

## Operating instructions

# PondoSolar 150

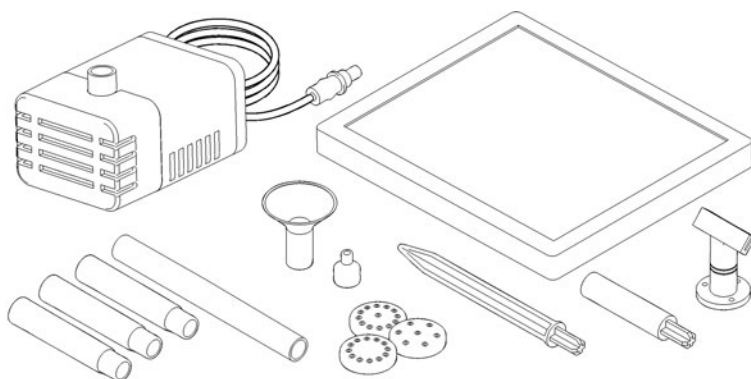
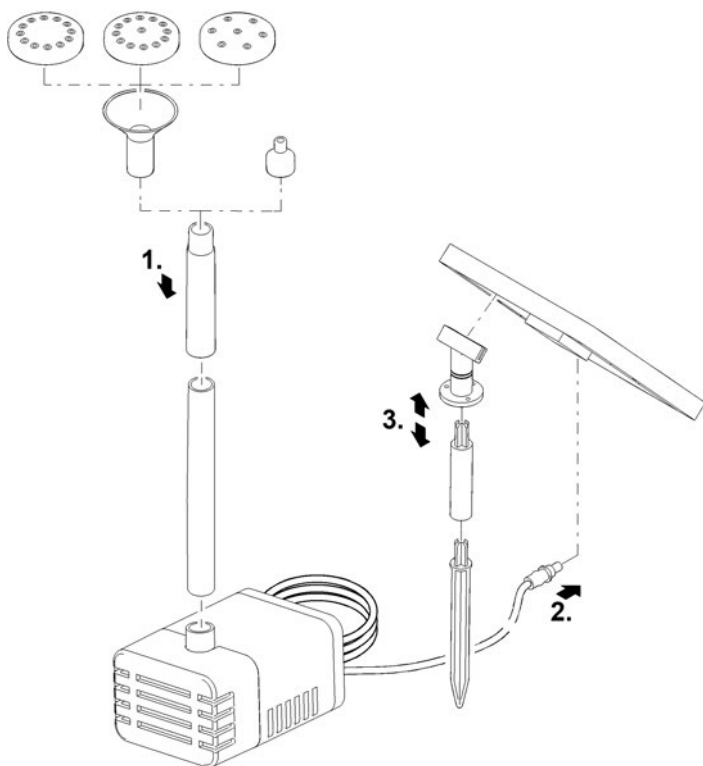

**B**

PSO0002

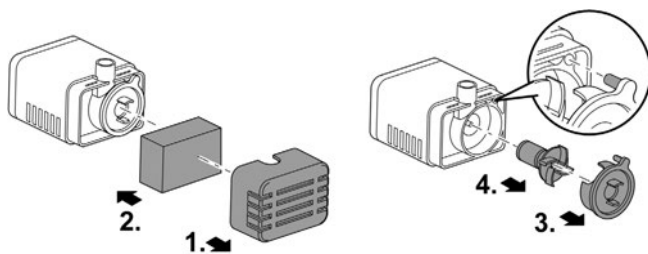
**C**

PSO0036

 **WARNING**

- ▶ Disconnect all electrical devices in the water from the power supply before reaching into the water. Otherwise there is a risk of severe injuries or death by electrocution.
  - ▶ This unit can be used by children aged 8 and above and by persons with reduced physical, sensory or mental capabilities or lack of experience and knowledge if they are supervised or have been instructed on how to use the unit in a safe way and they understand the hazards involved. Do not allow children to play with the unit. Only allow children to carry out cleaning and user maintenance under supervision.
- 

**Safety information**

- Do not carry or pull the unit by its electrical cable.
- Route cables/hoses such that they are protected from damage and do not present a tripping hazard.
- Only use original spare parts and accessories for the unit.
- Only operate the pump together with the supplied solar module.
- Do not allow the pump to run dry.
- Protect the unit from knocks or vibration.
- Clean the unit at least twice a year.
- The supply cord cannot be replaced. If the cord is damaged, the appliance should be scrapped.
- Protect disconnected plug connectors from moisture.

**Intended use**

Only use the product described in this manual as follows:

- For creating a water fountain in a pond.
- For operation with clean water.
- While adhering to the technical specifications.
- Adherence to the permissible water quality.

The following restrictions apply to the unit:

- Never use the unit with fluids other than water.
- Never run the unit without water.
- Do not use for commercial or industrial purposes.
- Do not use in conjunction with chemicals, foodstuff, easily flammable or explosive substances.
- Do not connect to the domestic water supply.

## Product Description

<input type="checkbox"/> A	Quantity	Description
1	1	Filter housing
2	1	Pump with outlet and 5 m connection cable
3	1	Nozzle holder
4	4	Nozzle attachment
5	1	Solar module
6	1	Ground stake set
7	4	Nozzle extension

## Installation and connection

How to proceed:

- B
1. Assemble the nozzle unit and fit onto the pump.
    - Adapt the number of nozzle extensions used to the depth of the pond.
  2. Connect the connection cable to the solar module.
    - Push the plug completely into the socket (up to the stop) to ensure that the connection is watertight.
    - Switching on: Connect the pump to the solar module.
    - Switching off: Disconnect the solar module from the pump.
  3. Assemble the ground stake set and attach it to the solar module.
    - Ensure that the connection cable is routed downwards.
  4. Install the unit in the pond in a horizontal position on firm, sludge-free ground and ensure that it is completely covered with water.
  5. Install the solar module so that it is exposed to direct sunlight.
    - Recommendation: Align the solar module to the sun to ensure maximum energy yield.

## Maintenance and cleaning

The unit has to be taken out of the water for cleaning or maintenance.

### Cleaning the device

- Never use aggressive cleaning agents or chemical solutions. These could attack the housing surface or impair the function.
- Recommended cleaning agent for removing stubborn limescale deposits:
  - Vinegar- and chlorine-free household cleaning agent.

How to proceed:

1. Disassemble the unit.
2. Clean the filter housing and impeller unit. (→ Replacing the impeller unit)
3. Pull the nozzle unit apart.
4. Clean all parts.
  - Use a soft brush as an aid.
  - Rinse parts in clean water.
5. Clean the solar module with a damp cloth and wipe dry.
6. Reassemble the unit in the reverse order.

### Replacing the impeller unit

How to proceed:

- C
1. Pull the filter housing from the pump.
  2. Remove the foam filter from the filter housing and rinse it out.
  3. Pull the cover off the impeller unit (push-fit fastening, lever out carefully).
  4. Pull out the impeller unit and clean or replace.
  5. Reassemble the unit in the reverse order.

## Storage/winter protection

If the ambient temperature leaves the permissible temperature range, uninstall the unit.

(→ Technical data)

- Thoroughly clean the unit.
- Check the unit for damage and replace damaged components.
- Store the pump submerged and in a frost-free environment.

## Malfunction remedy

Malfunction	Cause	Remedy
Pump does not start.	No connection to the solar module.	Connect the pump to the solar module. Correctly insert the connection cable.
	The solar module is soiled.	Clean
	The impeller unit is blocked	Clean
Insufficient or no pump delivery.	The filter is clogged.	Open the pump, remove and clean the filter.
	The nozzle unit is clogged.	Remove and clean the nozzle unit.
	The impeller unit is worn.	Replace
	Insufficient sunlight	Direct sunlight

## Wear parts

- Impeller unit

## Disposal



### NOTE



Do not dispose of this unit with household waste.

- ▶ Dispose of the unit by using the return system provided for this purpose.
- ▶ Should you have questions, please contact your local disposal company. They will give you information on how to correctly dispose of the unit.
- ▶ Render the unit unusable by cutting the cables.

## Guarantee conditions

PfG grants a 2 year guarantee from the date of sale on proven material and manufacturing faults. Wear parts such as bulbs etc. are exempted from the guarantee. Prerequisite for our guarantee is the presentation of the purchase receipt. Our guarantee will become null and void if the unit is misused, electrically or mechanically damaged by inappropriate use and improper repair by non-authorized workshops. Repairs are reserved for workshops authorised by PfG or by PfG itself. In the case of warranty claims, please return the defective unit or part freight paid to PfG together with a description of the fault and the purchase receipt. PfG reserves the right to invoice repair costs. PfG is not liable for transport damage. Any damage must be claimed against the carrier. Further claims of whatever type, especially consequential damage, are excluded. This guarantee does not affect the final customer's claims against the dealer.

GB	Dimensions	Rated voltage	Max. power	Max. flow rate	Max. head height	Immersion depth	Water temperature
	45 × 47 × 47 mm	6 V DC	/	≤ 150 l/h	≤ 0.6 m	≤ 0.6 m	+4 ... +35 °C
	220 × 190 × 25 mm	6 V DC	1.4 W	/	/	/	/

	<b>IP68</b> 		
	Dust tight. Submersible to 0.6 m depth.	Do not dispose of together with household waste!	Attention! Read the operating instructions

Pos.	Pondo Solar
	150
1	40770
2	85652

